

HWB WHEEL BRAKES – HYDRAULIC RELEASE

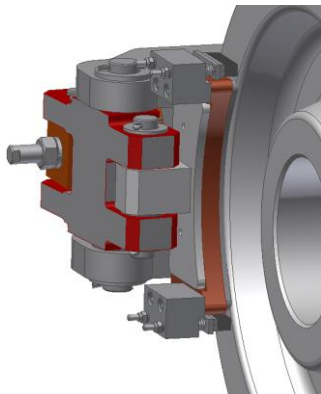

WB Wheel Brakes apply force generated by springs on the both sides of crane wheels. Oversized brake shoes with bonded friction material apply on the side flanges of idler wheels, providing the friction forces, and thus, braking capacity.

Designed as parking brakes to be applied when equipment comes to a full stop, WB wheel brakes can be also used as dynamic brakes in an emergency situation (e-stop). By applying spring force directly on the wheel flanges, they minimize the amount of stress and strain otherwise placed on sill beams and truck assemblies of a crane.

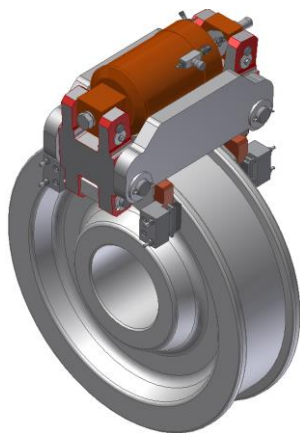

Applications:

- Ship to shore cranes
- Automated stacking cranes
- Wide Span Cranes
- Rail Mounted Gantry Cranes
- Log Handling Cranes
- Ship Loaders

Benefits

- Spring Set – Hydraulic Release
- Flow control valve installed on the brake for the controlled setting time 3 to 30 seconds
- Self-lubricating bushings and stainless steel pins on all pivot points
- Proximity switch for release indication signal
- Brake shoes easily removed and replaced
- Made with high quality structural steel
- Nominal retracted clearance 1mm per side. Recommended maximum clearance 2mm per side
- Equipped with shoe alignment device
- Supplied with release nut for mechanical brake release
- Operated and released by Brelex Hydraulic Power Unit HPU



HWB-Hydraulic Wheel Brake Dynamic Spring Set, Hydraulic Release shown

STANDARD FEATURES

- Fabricated from high quality structural steel.
- Brake shoes easily removed and replaced
- Paint system for C4 environment and 5 years warranty

SUPPLIED WITH BRELX HPU HYDRAULIC POWER UNIT

- Prewired junction box
- Hand pump for manual release
- Solenoid valve with manual override
- Solenoid coil with LED indicator

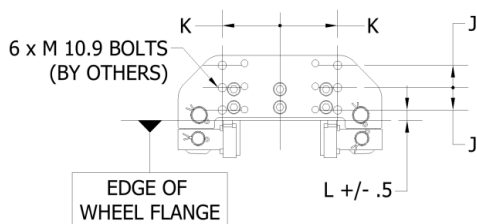
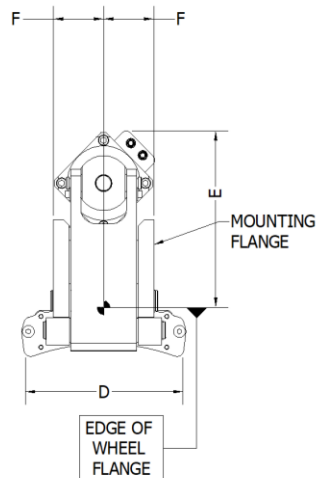
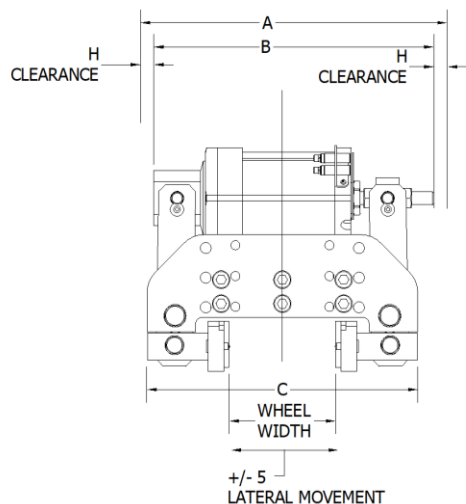

MODEL	HOLDING CAPACITY (kN)	A	B	C	D	E	F	H	J	K	L	M
HWB-30-A	30	600	535	500	315	330	75	30	50	125	25	M20
HWB-30-B									57	89	26	M20
HWB-60-A	60	600	535	500	315	330	75	30	50	125	25	M20
HWB-60-B									57	89	26	M20
HWB-90-A	90	600	535	550	315	330	110	30	55	145	30	M24
HWB-90-B									57	89	26	M20
HWB-120-A	120	600	535	550	315	330	110	30	55	145	30	M24
HWB-120-B									57	89	26	M20

Dynamic models braking capacities calculated with coefficient of friction factor 0.4
All dimensions (mm) and capacities (kN) subject to change without notification.